

**Glass Tank**  
**Walls for 2017 exhibitors**

For the remainder of the current exhibition programme (2017) we will be leaving the temporary walling system in place.

Please find information here about the wall space available, to assist you in the planning of your exhibition.

Floor Plan:

(Approximate measurements)



Cabinets  
(to scale)

BACK  
PERMANENT  
WALL

SIDE  
PERMANENT  
WALL

SMALL  
PERMANENT  
WALL

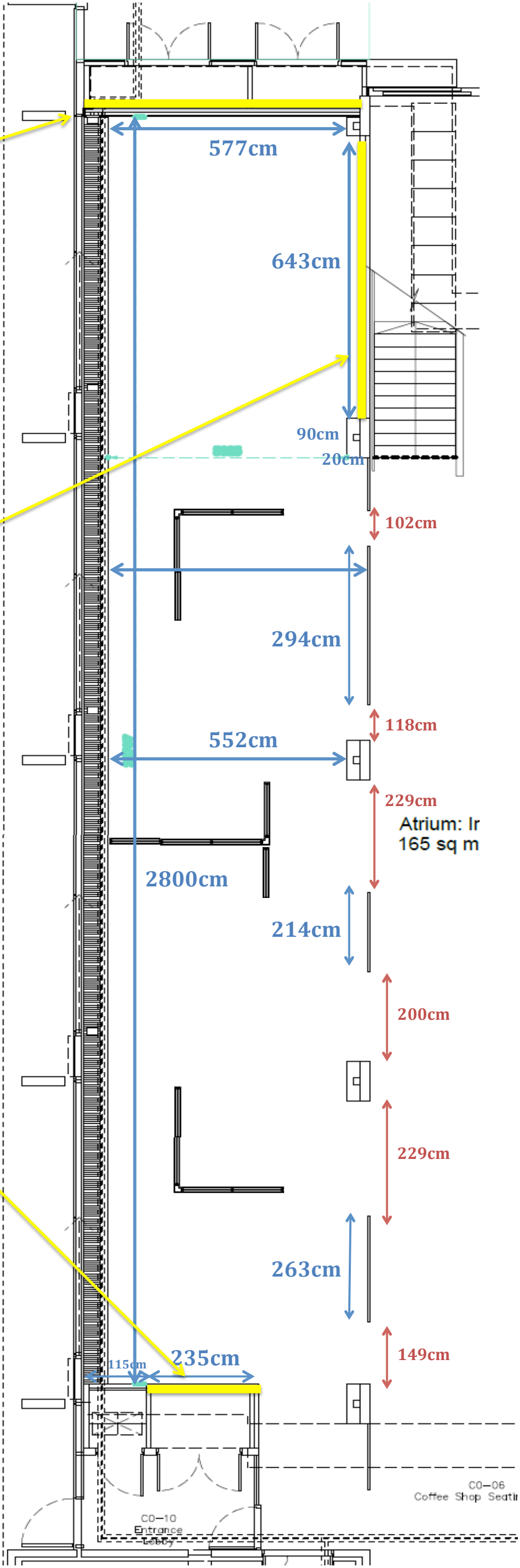

**BACK PERMANENT WALL - TO SCALE**

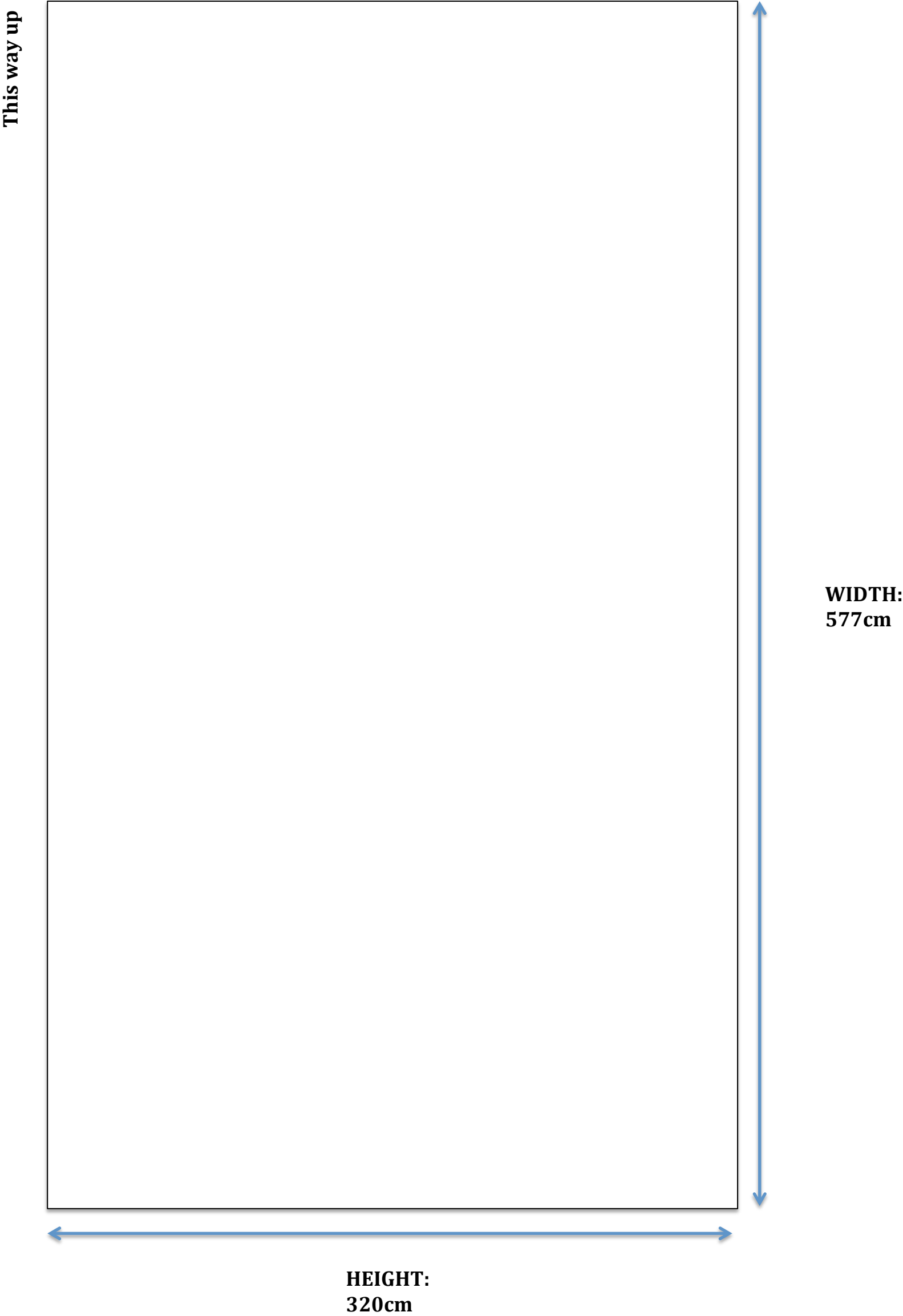

**SIDE PERMANENT WALL - TO SCALE**

This way up

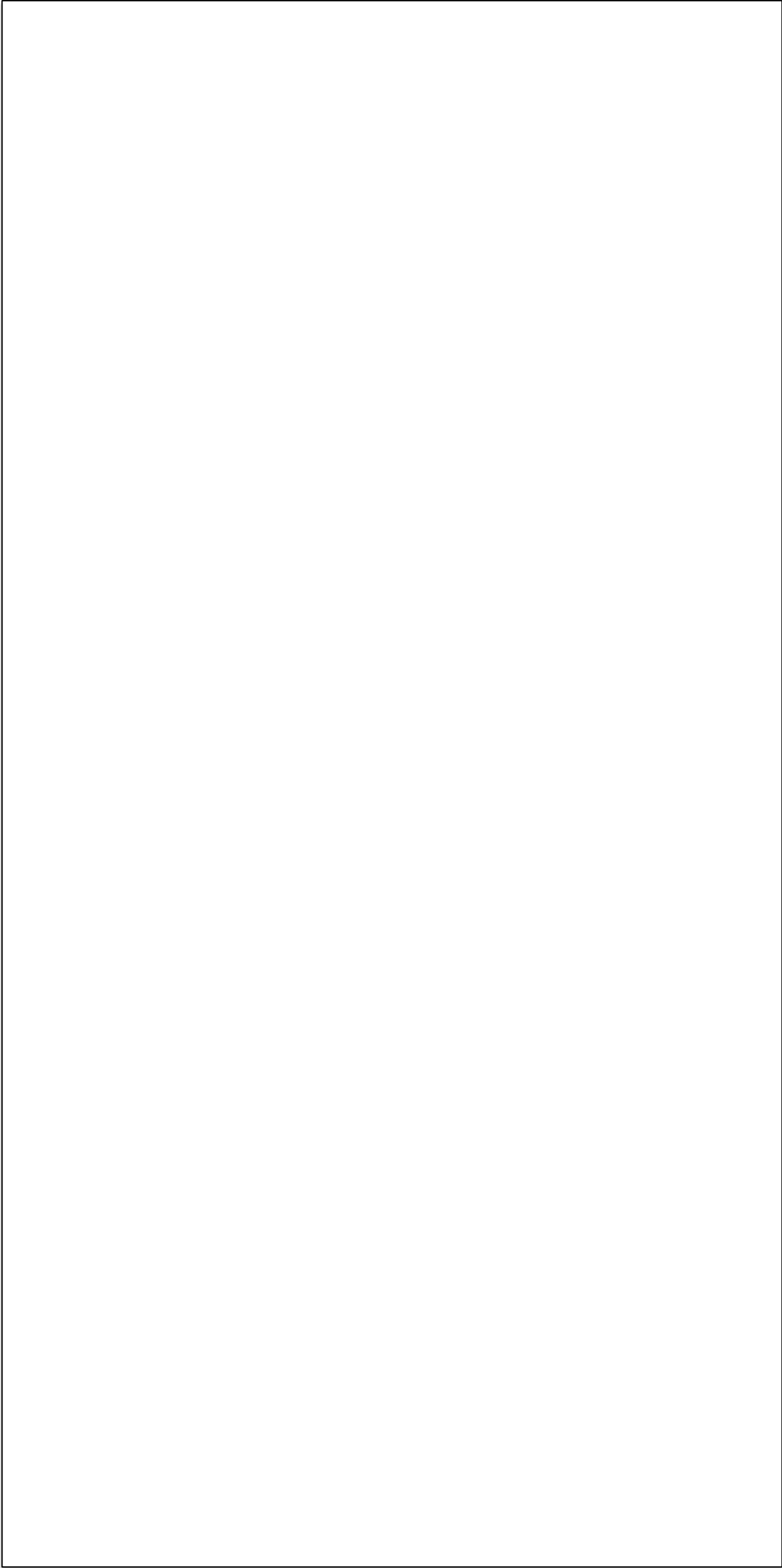

WIDTH:  
643cm

HEIGHT:  
320cm

**SMALL PERMANENT WALL - TO SCALE**

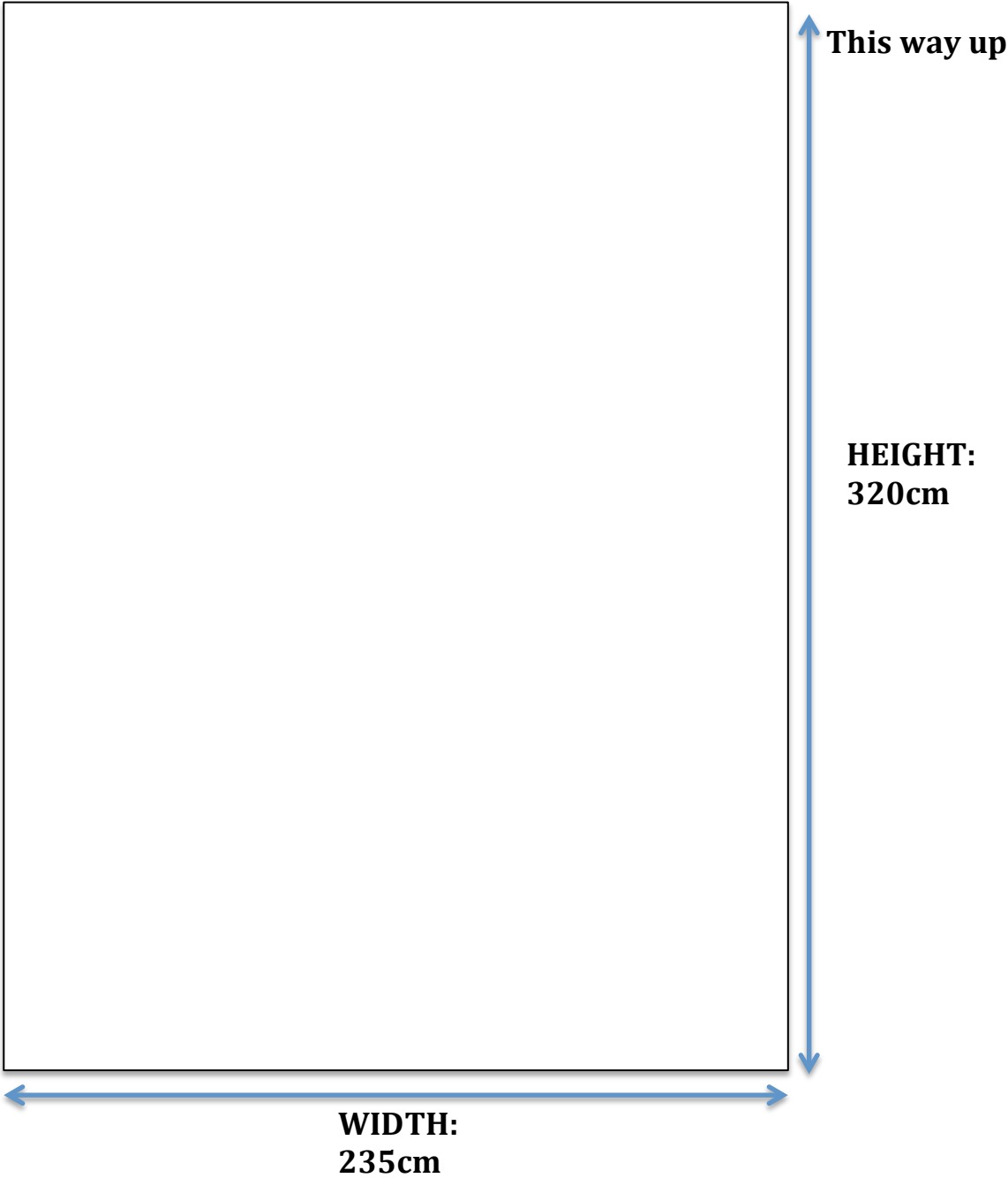

**CONCRETE PILLARS - TO SCALE**

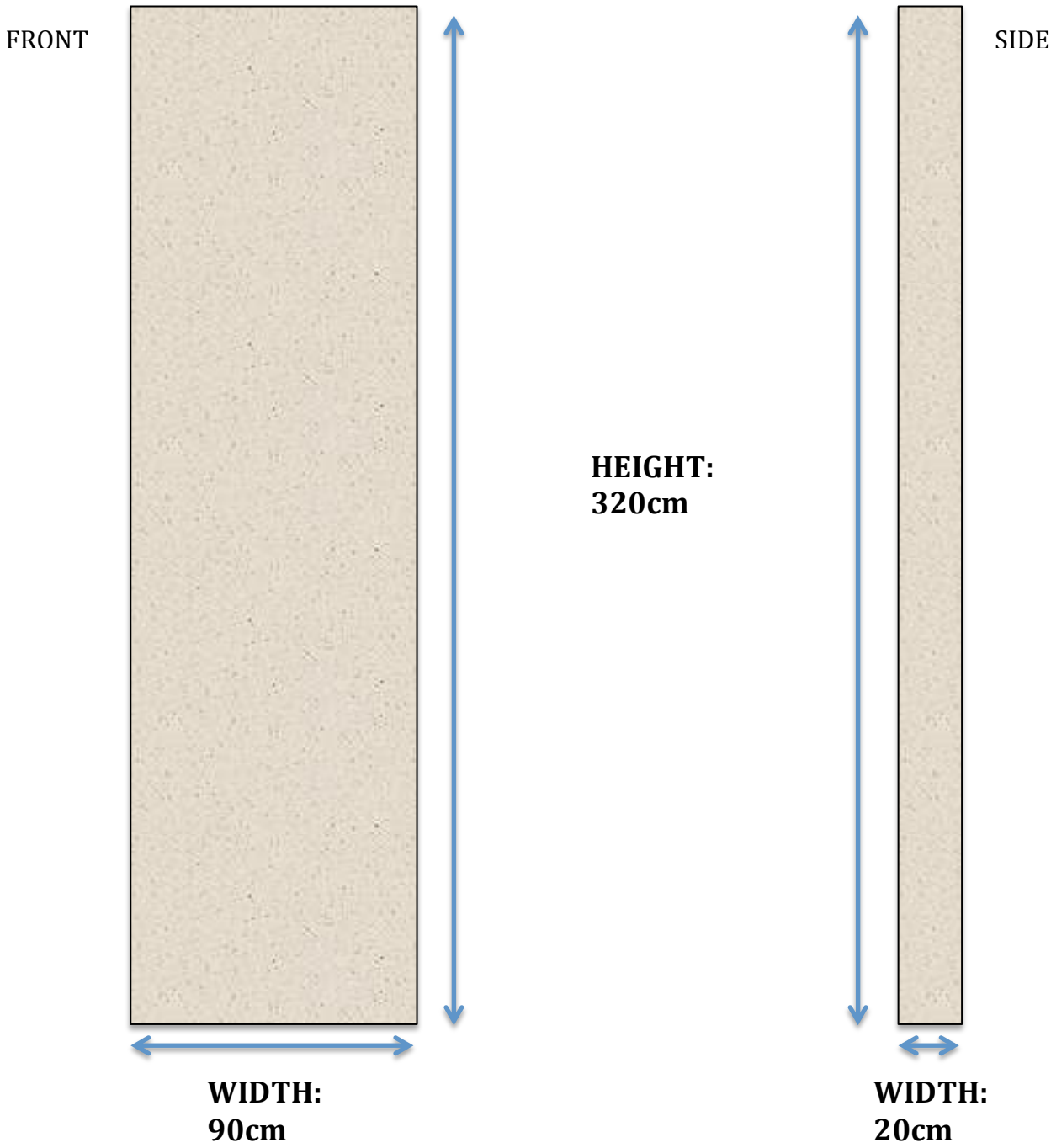

**TEMPORARY WALLING PANEL - TO SCALE**

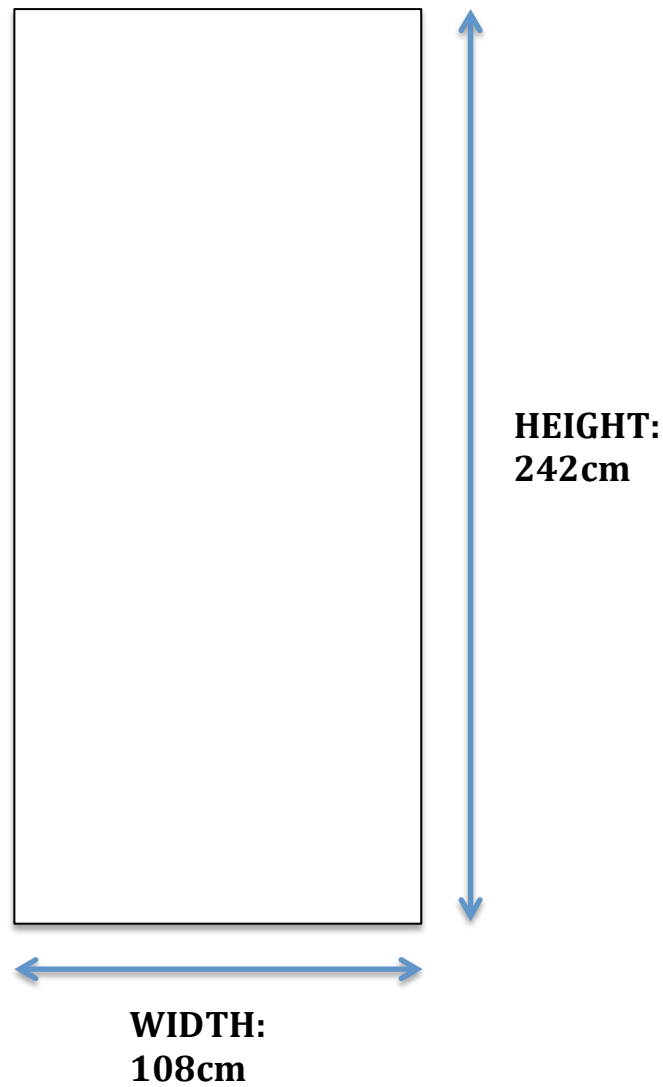

The current temporary walling arrangement consists of 2 ‘L’ shapes and 1 ‘T’ shape (see floor plan).

The T shape consists of 3 panels by 2 panels.  
Making a total of 10 panels.

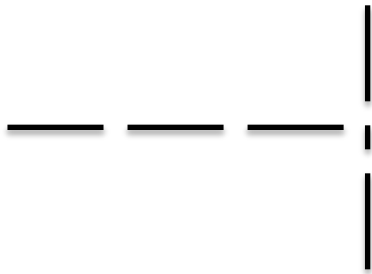

Both L’s consist of 2 panels by 2 panels.  
Making a total of 8 panels on each L.



**TEMPORARY WALLING – L-SHAPES**

**MEASUREMENTS ARE APPROXIMATE**

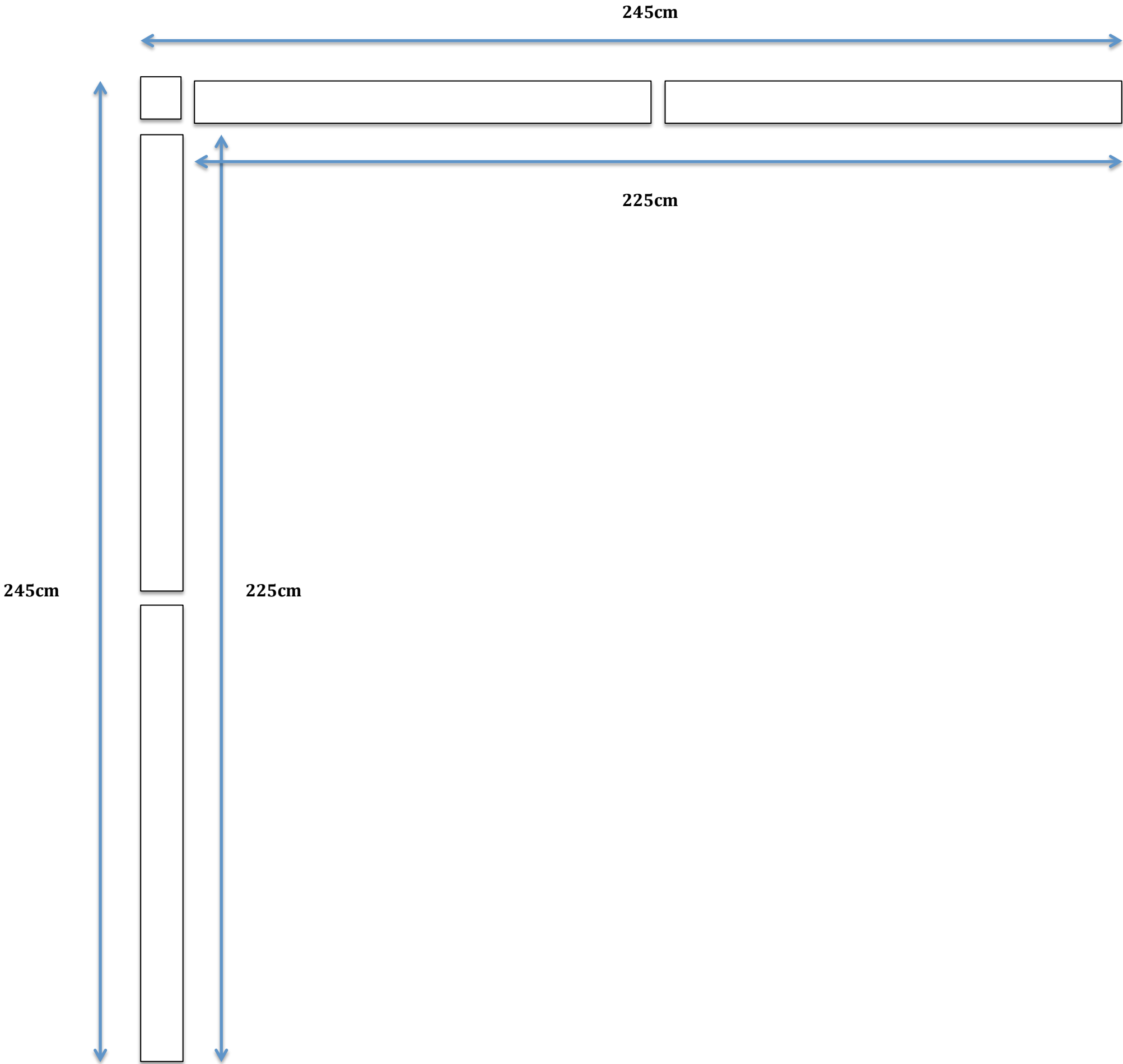

**TEMPORARY WALLING - T-SHAPE**

**MEASUREMENTS ARE APPROXIMATE**

